

iHESS-M series 1P Residential Energy Storage System

家用储能逆变器

ALL-IN-ONE

一体机

Present Solutions Expert

Inverter Module

Color

- a
- b
- c
- d



Battery Module
(Built-in Power Control Unit)

IP65 Rated IP65防护
Engineered to last with maximum flexibility.
Suitable for outdoor installaton

5 Years Warranty 5年保修
Supplied with a full manufacturers warranty

Simple 操作简单
All-in-one design
Modular installaton
Quick plug connector battery module
removable

Safe 安全
Sleep-class silence
Long battery life

Product application diagram 工作原理图

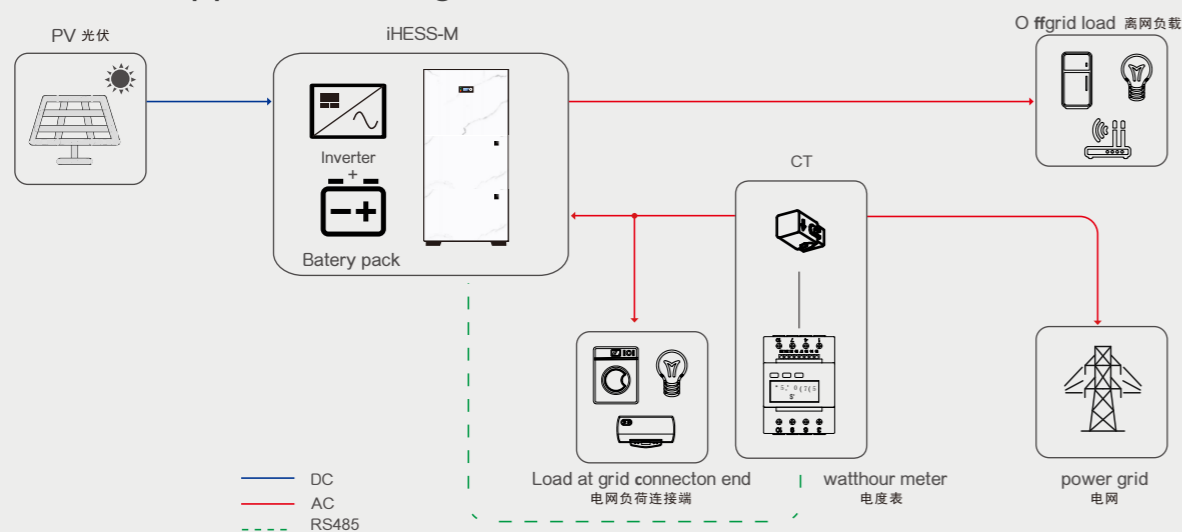

| Technical Specificaaoon 产品系列 | iHESS-M series |
|--|--|
| EFFICIENCY 效率 | |
| DC Max. efficiency 直流最大功率 | 97.50% |
| Europe efficiency 欧洲效率 | 97% |
| INPUT(PV) 输入 (PV) | |
| Max. power(kW) 最大功率 | 9.6 |
| Max. DC voltage(V) 最大直流电压 | 550 |
| MPPT voltage range(V) MPPT电压范围 | 90~500 |
| Max.input current of single MPPT(A) 单个MPPT的最大输入电流 | 16/16 |
| MPPT tracker/strings MPPT数量/各最大并联组串数 | 2/1 |
| AC OUTPUT 交流输出 | |
| Rated output power(kW) 额定输出功率 | 6 |
| Max. output current(A) 最大输出电流 | 26 |
| Grid voltage/range(V) 电网电压/范围 | 230/176~270 |
| Frequency (Hz) 频率 | 50 /60 |
| PF 功率因数 | 0.8lagging-0.8leading 0.8滞后-0.8超前 |
| THDi 电流谐波 | <3% |
| AC output topology 过载能力 | L+N+PE |
| BATTERY 电池 | |
| Batery voltage range(V) 蓄电池电压范围 | 40~58 |
| Max. charging voltage(V) 最大充电电压 | 58 |
| Max. charge/discharge current(A) 最大充放电电流 | 100/110 |
| Batery type 电池类型 | Lithium /Lead-acid 锂/铅酸 |
| UPS OUTPUT UPS输出 | |
| Rated power (kW) 额定功率 | 6 |
| Rated output voltage(V) 额定输出电压 | 230 |
| Rated output current(A) 额定输出电流 | 26 |
| Rated frequency (Hz) 额定频率 | 50/60 |
| Transfer Time(ms) 切换时间 | <10 |
| THDi 电流谐波 | <2% |
| Overload capacity 交流输出拓朴 | 110%, 30S/120%, 10S/150%, 0.02S |
| PROTECTION& FEATURE 保护和功能 | |
| Ant-Island proteccion 孤岛保护 | Yes |
| DC overcurrent protecton 直流过电流保护 | Yes |
| Insulaton monitoring 绝缘监测 | Yes |
| Residual current monitoring 剩余电流监测 | Yes |
| Arc fault protection 电弧故障保护 | Optional |
| Batery reverse polarity proteccion 电池反极性保护 | Yes |
| Parallel Functon 并行 | Yes,6 units 有, 可6台并机 |
| Other protecton 其他保护 | AC overcurrent, AC overvoltage, Over temperature protection 交流过电流、交流过电压、过热保护 |
| BATTERY MODULE 电池模块 | |
| Model 模型 | SL-M48100 |
| Batery type 电池类型 | LiFePo4 |
| Batery module energy | 5.12KWh |
| Max charge current&discharge current 最大充电电流和放电电流 | 100A |
| Dimensions W x D x H (mm) 尺寸 | 640*200*400 |
| Net Weight(KG) 重量 | 54 |
| GENERAL PARAMETER 常规参数 | |
| Degree of protection 防护等级 | IP65 |
| Operaton temperature 工作温度 | - 25°C~ 60°C |
| Cooling 冷却 | Natural 自然的 |
| Relative humidity 相对湿度 | 0~95%(non-condensing) 0~95%(凝结的) |
| Altitude 海拔 | (>2,000m Deratng) |
| Dimensions W * D * H (mm) 尺寸 | 480*210*495 |
| Net Weight(KG) 重量 | 25 |
| Isolaton transformer 隔离变压器 | No |
| Self-consumpton(W) 自耗 | <5 |
| DISPLAY AND COMMUNICATION 显示和通信 | |
| Display 显示器 | LCD |
| Interface 界面 | Standard:RS485,CAN,DRM Optional:Wi fi,Bluetooth |
| Safety standard 安全标准 | CE-EMC/ENIEC 61000-6-3:2021,ENIEC61000-6-1:2019,CEVOC/IEC 62109-1:2010,IEC62109-2:2011,IEC 62477-1: 2022 COC/VE4105:2018, VDE0124:2020;COC/CE10-21:2022;COC/TORTvpeA/B:2022, OVER25:2020;G98:2022, G99:2022 |